

INTRODUCING THE POST-16 CAMPUS

On behalf of the Committee for Education, Sport & Culture, I am delighted to be able to share with you this summary of the detailed plans for the new post-16 campus at Les Ozouets. The new campus will be a centre of ambition and aspiration for all learners progressing from our three 11-16 schools. Students will graduate to the campus, irrespective of their learning pathway, to join a mature, adult learning environment which will prepare them for their next steps into education or the world of work.

The submission of the planning application is an exciting milestone on the journey towards the new purpose-built facility for The Guernsey Institute (TGI) and the Sixth Form Centre. We hope you enjoy this visual summary of the development, which includes details of the design of the campus, specifics of the site plans, and providing an overview

of the exciting and fantastic facilities that will be in place for the benefit of the whole island as part of our commitment to investing in our young people and lifelong learning.

We've also included in this summary details that we hope will reassure anyone concerned, especially neighbours who we want to work with, about the impact of the development on the surrounding area, specifically in terms of traffic. We have been very reassured by a thorough independent traffic assessment, which has recently been undertaken. Further details of this and measures to minimise the impact of the campus and enhance the natural environment can be found on the back page.

Thank you for taking the time to read this summary. Our Committee is incredibly excited about the development of the new post-16 campus and is committed to keeping the community informed on every step of the journey between now and delivery of the fully operational site in September 2025.

DEPUTY ANDREA DUDLEY-OWEN
President for the Committee for
Education, Sport & Culture

15,000M²

of internal education & community spaces including
the existing Princess Royal Centre for Performing Arts

1,700M²

of internal sport and
recreation space





The buildings provide backdrops for a series of piazzas (external spaces)



These spaces and the buildings are supported by access roads and car parking areas, all enclosed within the planted site boundary



Social outdoor spaces for students to break out and relax across the campus



Value of biodiversity, ecology and green areas recognised through piazzas and landscaping



Shared spaces between TGI and Sixth Form Centre

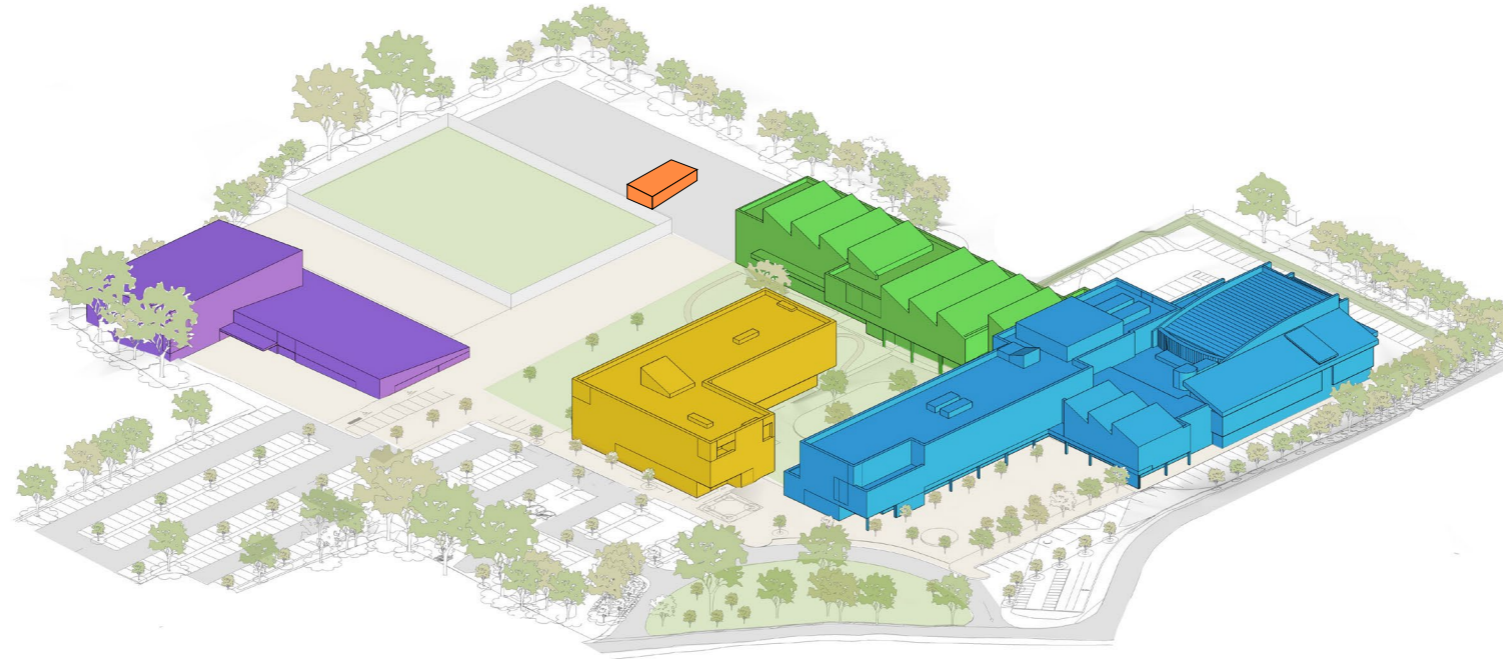

HORTICULTURE BUILDING

- ✓ Standalone building with classroom. Close access to planted areas of the site
- ✓ Adjacent to allotments
- ✓ Building and associated external areas form a horticultural zone



SPORTS CENTRE AND MUGA*

- ✓ 1,600m² of sports provision for teaching and **community use**
- ✓ **4-court full-sized sports** hall suitable for a variety of sports
- ✓ A seated spectator area
- ✓ Plenty of sport-oriented teaching spaces in the same building
- ✓ Changing areas which also lead out to the **external sports areas** to the east
- ✓ Space for examinations when needed

*Multi-use games area



SIXTH FORM CENTRE

- ✓ Accommodated over three floors with dedicated learning and study areas
- ✓ An atrium spanning all floors providing spaces for individual and communal study, and a self-catering area
- ✓ Teaching rooms with **specialised facilities** in art & design, media, photography, ICT and computer science



TGI MAIN BUILDING

- ✓ 5,300m² of new teaching accommodation and community facilities across three floors
- ✓ **Specialist** facilities for nurse training, art students, hair and beauty and much more
- ✓ Built around the **existing Princess Royal Centre for Performing Arts** to incorporate its excellent theatre facilities
- ✓ Containing a central café area to act as **a hub for the campus**
- ✓ Art faculty with specialist studios on second floor
- ✓ GTA University Centre with **business-orientated spaces** on third floor



CONSTRUCTION AND ENGINEERING BUILDING

- ✓ A dedicated building for construction and engineering with **2,735m² of classrooms and workshops**
- ✓ Design and technology workshop and classroom for Sixth Form Centre
- ✓ Scissor lifts and maintenance lifts to ensure easy access for heavy materials
- ✓ Connected to the main building and **café/atrium hub** at ground and first floor levels

Architectural drawings, could be subject to change.

TRAFFIC

A comprehensive assessment of the anticipated traffic impact of the new campus when fully operational has been carried out by Ove Arup & Partners Ltd. Any increase in traffic in the area is not deemed to be significant.

TGI will generate approx. 312 journeys at the daily peak. The majority will be existing trips on the local road networks to and from the campuses at Les Ozouets and La Coutanchez.

The Sixth Form Centre will generate no additional journeys, they will just be re-routed from the current Sixth Form Centre just down the road.

Opportunities for better access for cyclists and pedestrians and improved public transport links are also being explored.

The report **recommends** the following new traffic measures:



Traffic lights installed at the Les Baissières/Le Friquet junction



Phasing time of the traffic lights at the Les Ozouets Road/Foote's Lane/ and the Fosse Andre/La Couture/Collings Road/Rozel Road junctions increased from 90 seconds to 120 seconds



Two new pedestrian crossings installed on Les Ozouets road and improved visibility of crossing on Le Couture

PRESERVING AND ENHANCING GREEN SPACE

- ✓ Retaining much of the grassland area, mature trees and woodland screening in the main car park
- ✓ Preserving the Sweet Chestnut near centre of site, an icon of the original St Peter Port School
- ✓ Woodland area to be used as an outdoor education facility
- ✓ New meadow habitat, incorporating existing pond and mature Alder trees
- ✓ Green spaces in the multiple piazzas throughout the campus

KEEPING THE NOISE DOWN

Extensive assessments were carried out by noise specialists Sandy Brown Consultants to establish how much noise the campus will make - from the general hubbub of everyone on-site, sporting activities and general sounds from the buildings. All are expected to be within acceptable levels, causing no adverse impact on the surrounding neighbourhood.

